



JLD VACUUM JOINT LEAK DETECTOR OPERATING MANUAL



www.USAIindustries.com

(713) 941-3797 • (800) 456-8721

315 State Street • S. Houston, TX 77587



JLD VACUUM JOINT LEAK DETECTOR OPERATING INSTRUCTIONS

FEATURES:

- Simple, Quick and Reliable tube joint testing. Test 10 tube joints per minute.
- Interchangeable seal sets : Allows testing of tube joints from 7.75 mm to 30.63 mm ID with easy to replace accessories. Joint Testing Gun weights less than 1.5 kg.
- Air supply : Uses standard plant air supplies from 70 psi to 100 psi (4.7 to 6.8 bar).
- Silent during use. Ergonomic design makes testing effortless.
- Each Kit packed in compact and handy case.

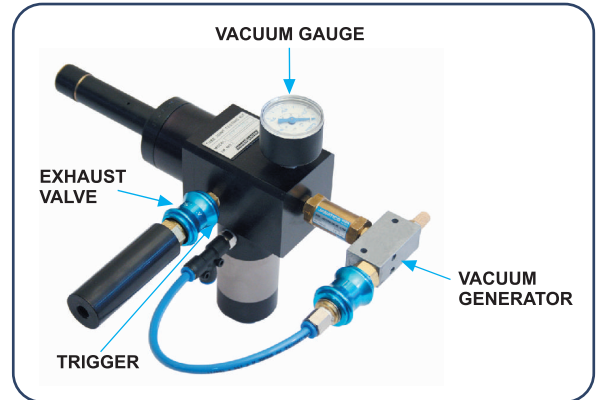

SEQUENCE OF OPERATION:

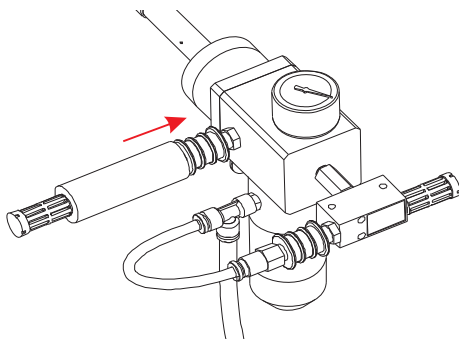

A) Close exhaust valve by sliding it to extreme right.

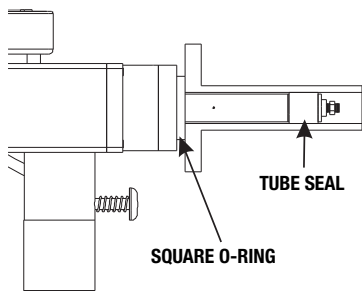

B) Insert manifold until square o-ring sits on the tube.

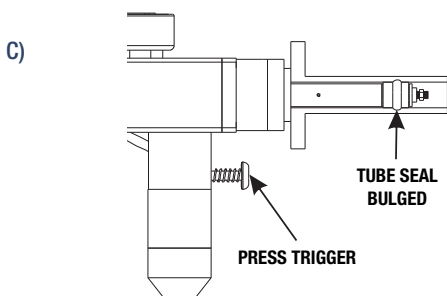

C)

D) Slide vacuum valve to the right to start generating vacuum. Gauge will indicate vacuum level.

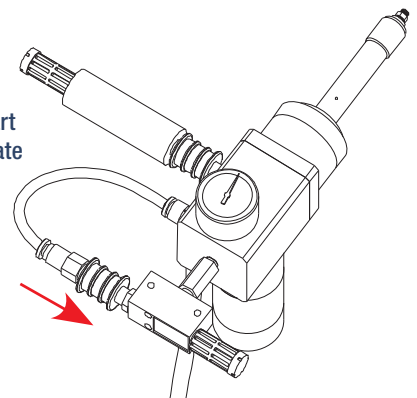

E) Close vacuum slide valve by shifting to the left. This will stop vacuum generation. Observe vacuum gauge. The vacuum level falls if the joint is leaking.

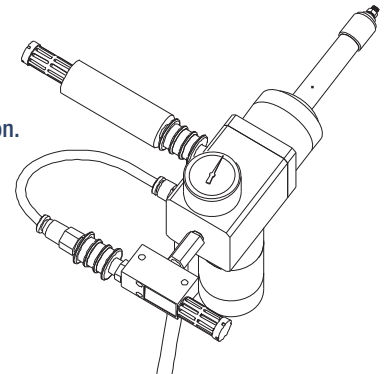

F) After testing the joint, release the tube seal by sliding the exhaust to the left. The Joint Testing Kit can be withdrawn after the tube seal collapses.

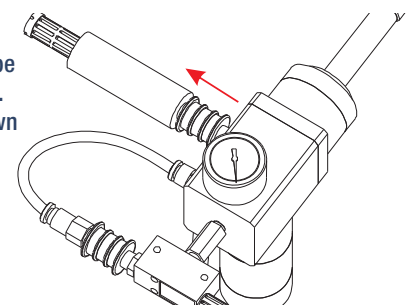



JLD VACUUM JOINT LEAK DETECTOR OPERATING INSTRUCTIONS

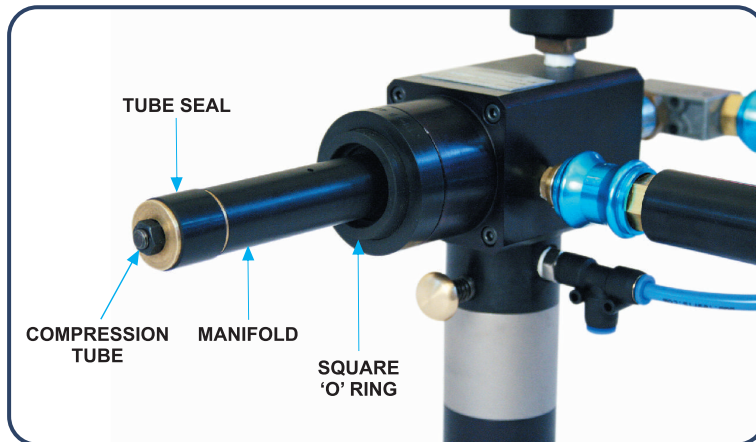

| Tube Size | | Tube ID Range | | Tube Seal Part No. | Tube Seal Diameter | | Manifold with Square O ring | Compression Tube Part No. | Square O ring |
|-----------|---------|---------------|---------------|--------------------|--------------------|-------|-----------------------------|---------------------------|---------------|
| O.D. | bwg | mm | inch | | mm | inch | | | |
| 5/8" | 9 | 8.37 | .330 | JTK-300N | 7.5 | .295 | JTM-15-125-5/8 | JTK-15-125 | JTK-16-5/8 |
| | 10-13 | 9.07 - 11.05 | .357 - .435 | JTK-370N | 9 | .354 | | | |
| | 14-15 | 11.67 - 12.23 | .459 - .481 | JTK-450N | 11.6 | .457 | | | |
| | 16-17 | 12.57 - 12.93 | .495 - .509 | JTK-470N | 12.2 | .480 | | | |
| | 18-19 | 13.39 - 13.75 | .527 - .541 | JTK-490N | 13.3 | .523 | | | |
| | 20-24 | 14.11 - 14.77 | .555 - .581 | JTK-530N | 13.8 | .543 | JTM-15-312-5/8 | JTK-15-312 | |
| 3/4" | 9 | 11.55 | .455 | JTK-430N | 10.8 | .425 | JTM-15-312-3/4-1 | JTK-15-312 | JTK-16-3/4 |
| | 10 - 11 | 12.25 - 12.95 | .482 - .510 | JTK-450N | 11.6 | .457 | JTM-15-125-3/4 | JTK-15-125 | |
| | 12 - 13 | 13.53 - 14.23 | .532 - .560 | JTK-490N | 13.3 | .523 | JTM-15-312-3/4-2 | JTK-15-312 | |
| | 14 - 15 | 14.85 - 15.41 | .584 - .606 | JTK-530N | 13.8 | .543 | | | |
| | 16 - 17 | 15.75 - 16.11 | .620 - .634 | JTK-570N | 15.4 | .606 | | | |
| | 18 - 24 | 16.57 - 17.95 | .652 - .706 | JTK-610N | 16.5 | .649 | | | |
| 7/8" | 8-9 | 13.84 - 14.72 | .544 - .579 | JTK-530N | 13.8 | .543 | JTM-15-312-7/8-1 | JTK-15-312 | JTK-16-7/8 |
| | 10-11 | 15.42 - 16.12 | .607 - .635 | JTK-570N | 15.4 | .606 | | | |
| | 12-13 | 16.7 - 17.4 | .657 - .685 | JTK-610N | 16.5 | .649 | | | |
| | 14-17 | 18.02 - 19.28 | .709 - .759 | JTK-690N | 18 | .708 | | | |
| | 18-19 | 19.74 - 20.1 | .777 - .791 | JTK-740N | 19.7 | .775 | | | |
| | 20-24 | 20.46 - 21.12 | .805 - .831 | JTK-790N | 20.1 | .791 | JTM-15-312-7/8-2 | | |
| 1" | 8-9 | 17.02 - 17.9 | .670 - .704 | JTK-610N | 16.5 | .649 | JTM-15-312-1 | JTK-15-312 | JTK-16-1 |
| | 10-11 | 18.6 - 19.3 | .732 - .760 | JTK-690N | 18 | .708 | | | |
| | 12-13 | 19.88 - 20.58 | .782 - .810 | JTK-740N | 19.7 | .775 | | | |
| | 14-15 | 21.2 - 21.76 | .834 - .856 | JTK-790N | 20.1 | .791 | | | |
| | 16-17 | 22.1 - 22.46 | .870 - .884 | JTK-840N | 21.7 | .854 | | | |
| | 18-19 | 22.92 - 23.28 | .902 - .916 | JTK-870N | 22.9 | .901 | | | |
| 1.1/8" | 8-9 | 20.19 - 21.07 | .795 - .829 | JTK-790N | 20.1 | .791 | JTM-15-312-1.1/8 | JTK-15-312 | JTK-16-1.1/8 |
| | 10-11 | 21.77 - 22.47 | .857 - .884 | JTK-840N | 21.7 | .854 | JTM-15-405-1.1/8 | JTK-15-405 | |
| | 12-13 | 23.05 - 23.75 | .907 - .935 | JTK-870N | 22.9 | .901 | | | |
| | 14-15 | 24.37 - 24.93 | .959 - .981 | JTK-890N | 23.3 | .917 | | | |
| | 16-17 | 25.27 - 25.63 | .994 - 1.009 | JTK-980N | 25.2 | .992 | | | |
| | 18-19 | 26.09 - 26.45 | 1.027 - 1.041 | JTK-990N | 26.0 | 1.024 | | | |
| | 20-24 | 26.81 - 27.47 | 1.055 - 1.081 | JTK-1040N | 26.8 | 1.055 | | | |
| 1.1/4" | 8-11 | 23.37 - 25.65 | .920 - 1.01 | JTK-890N | 23.3 | .917 | JTM-15-405-1.1/4 | JTK-15-405 | JTK-16-1.1/4 |
| | 12-13 | 26.23 - 26.93 | 1.032 - 1.060 | JTK-990N | 26.0 | 1.024 | | | |
| | 14-17 | 27.55 - 28.81 | 1.084 - 1.134 | JTK-1090N | 27.5 | 1.082 | | | |
| | 18-24 | 29.27 - 30.65 | 1.152 - 1.206 | JTK-1100N | 29.2 | 1.149 | | | |